

AIRCRAFT APPLICATION SHEET

91/498T2 HOIST KIT

A380 APU HOIST KIT (FAL)

REV 5 TOP SHEATH 43/1774 REPLACED BY 43/1962
 ANGLE CHANGER 43/336 REPLACED BY 43/1965

didsbury

World class lifting and handling solutions

Didsbury Engineering Co Ltd

Telephone: +44 (0)161 486 2200
 Facsimile: +44 (0)161 486 2211
 Email: sales@didsbury.com
 Web: www.didsbury.com

ITEM NO.	PART No.	DESCRIPTION	QTY.
1	43/136	EXTENSION TUBE COUPLING	2
2	43/910	343mm 180° OFFSET EXTENSION TUBE	2
3	43/1695	CLAMP SHELL ASSEMBLY	2
4	43/1746T3	1143mm 40° OFFSET EXTENSION TUBE	1
5	43/1746T4	845mm 40° OFFSET EXTENSION TUBE	1
6	43/1787	SHACKLE ASSY	2
7	43/1962	TOP SHEATH	2
8	43/1965	ANGLE CHANGER ASSEMBLY - 106°	2
9	91/8T5	CABLE ASSEMBLY (FOR REFERENCE ONLY)	2
10	91/263	91/16 WINDING MECHANISM WITH FIXED TUBE	2
11	91/670	WINDING HANDLE - FINE TORQUE CONTROL	2

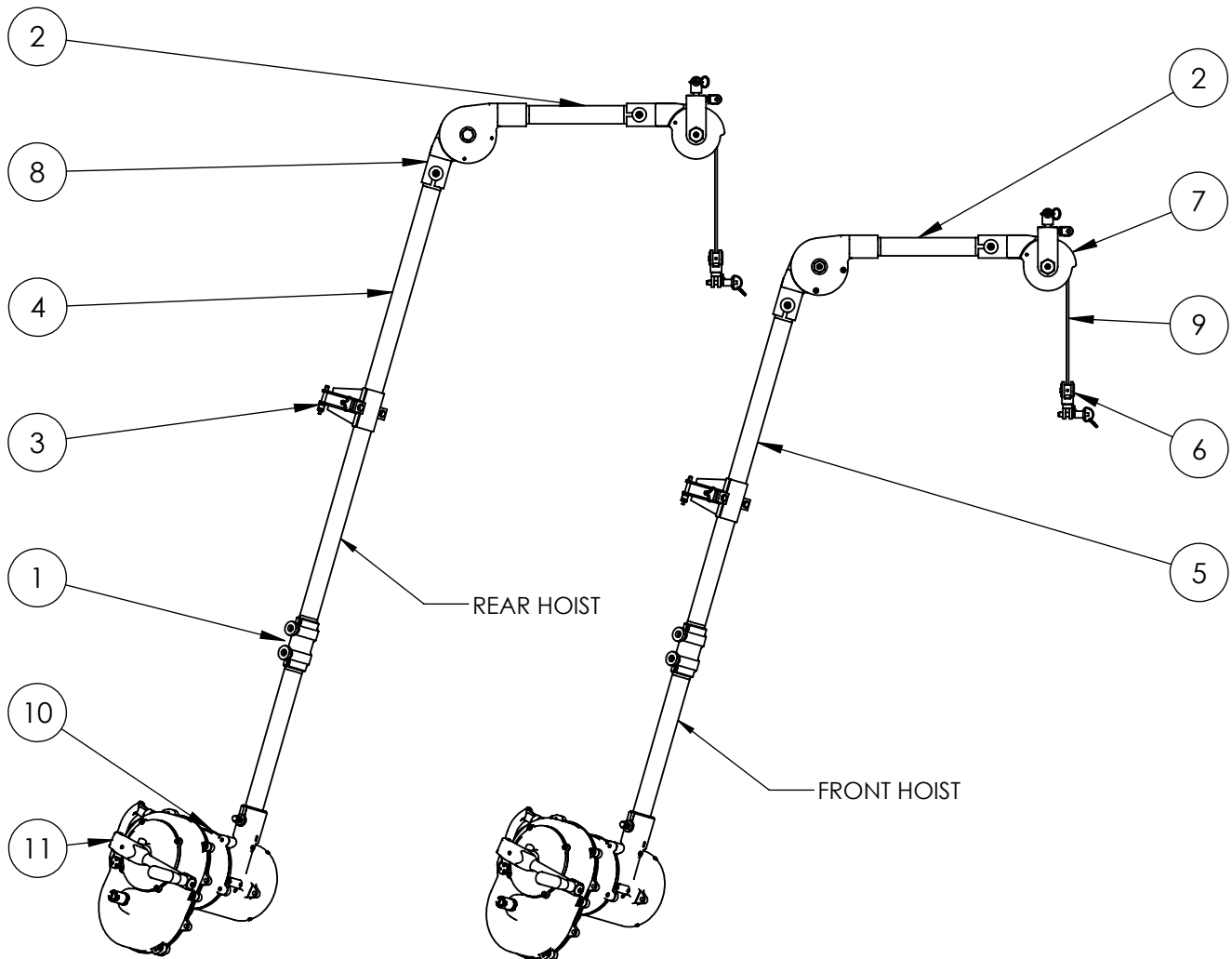

HEIGHT OF LIFT: 6900mm
 SWL: 508kg Per Hoist
 WEIGHT: 36kg Per Hoist

NOTE
 EACH HANDLE TO BE SET TO DISENGAGE AT 500kg
 SEAL SCREW WITH SILICONE AFTER SETTING

DRAWN: ADB DATE: 8/01/15 REV. 5