

# AIRCRAFT APPLICATION SHEET

## 10/3641 HOIST KIT

### FISHPOLE HOIST KIT

# didsbury

World class lifting and handling solutions

**Didsbury Engineering Co Ltd**

Telephone: +44 (0)161 486 2200  
 Facsimile: +44 (0)161 486 2211  
 Email: sales@didsbury.com  
 Web: www.didsbury.com

ITEM NO.	PART No.	DESCRIPTION	QTY.
1	10/4054	FISHPOLE HOIST ASSEMBLY	1
2	41/110	EXTENSION TUBE COUPLING	2
3	41/468	406mm EXTENSION TUBE	1
4	41/100	610mm EXTENSION TUBE	1
5	41/453	698mm EXTENSION TUBE	1
6	41/102	1219mm EXTENSION TUBE	1
7	91/659	TOP SHEATH ASSY	1
8	46/1181	9" WINDING HANDLE	1
9	10/4069	SHACKLE ASSEMBLY	1
10	46/317T2	CABLE ASSEMBLY (FOR REFERENCE ONLY)	1

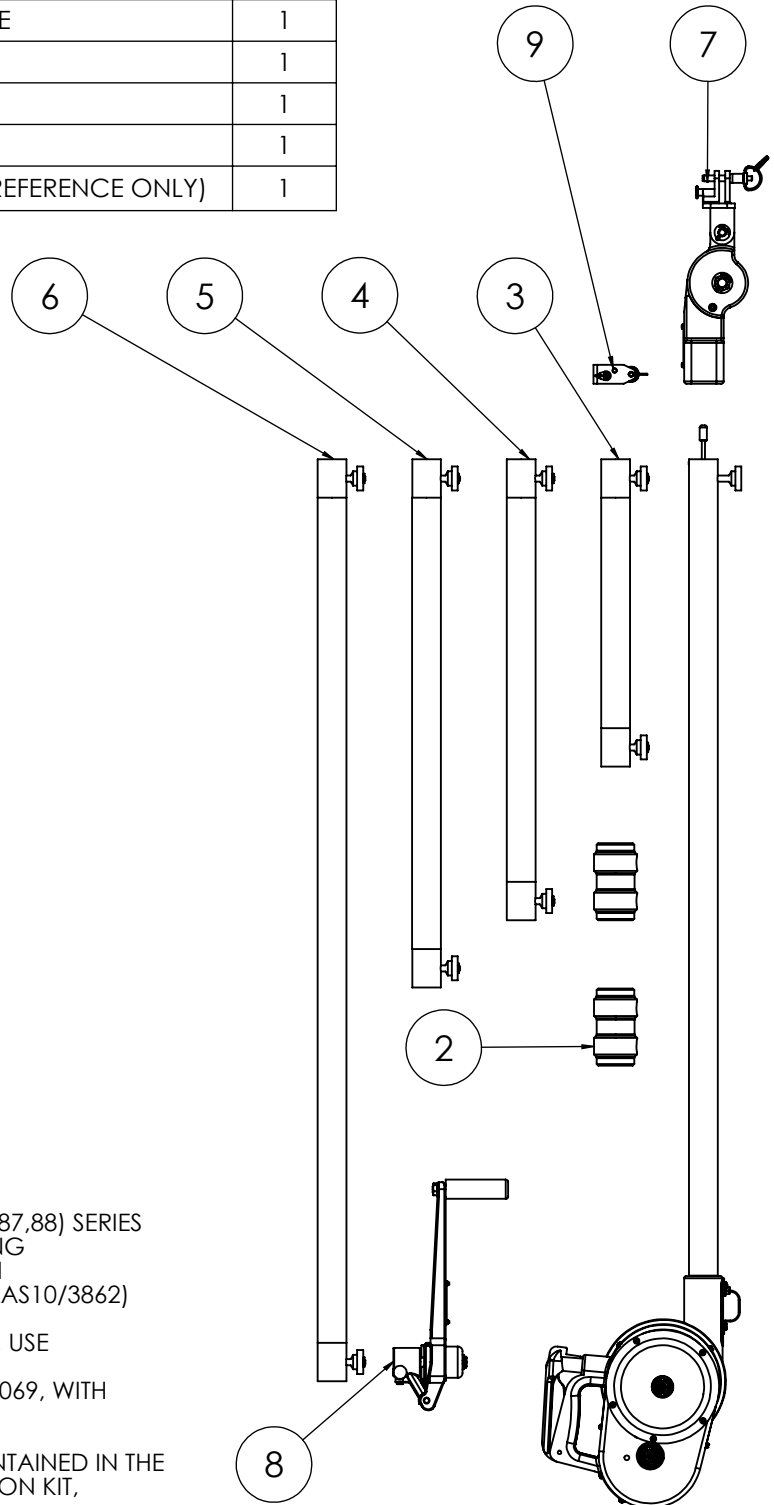

NOTE  
 FOR McDONNELL DOUGLAS DC9, (MD 80,81,82,83,87,88) SERIES  
 APU HANDLING, USE CONFIGURATION 1 REPLACING  
 TOP SHEATH, 91/659, AND SHACKLE, 10/4069, WITH  
 TOP SHEATH, 10/3858, AND HOOK, 10/3860, (SEE AAS10/3862)

FOR McDONNELL DOUGLAS DC10 APU HANDLING, USE  
 CONFIGURATION 2  
 WITH TUBE 41/453 AND REPLACING SHACKLE, 10/4069, WITH  
 SHACKLE 10/3859, (SEE AAS10/3863)

THE ADDITIONAL EQUIPMENT LISTED ABOVE IS CONTAINED IN THE  
 McDONNELL DOUGLAS APU HANDLING CONVERSION KIT,  
 DIDSBURY PART NUMBER 10/3861.

SWL: 254Kg

REV. 9 13/04/17 ADB

# AIRCRAFT APPLICATION SHEET

## 10/3641C1 HOIST KIT

## FISHPOLE HOIST KIT

CONFIGURATION 1:

BOEING 737, 737 MAX, CLASSIC, NG AND B737BBJ APU R/I

BOMBARDIER C SERIES APU R/I

# didsbury

World class lifting and handling solutions

**Didsbury Engineering Co Ltd**

Telephone: +44 (0)161 486 2200

Facsimile: +44 (0)161 486 2211

Email: sales@didsbury.com

Web: www.didsbury.com

ITEM NO.	PART No.	DESCRIPTION	QTY
1	10/4054	FISHPOLE HOIST ASSEMBLY	2
2	91/659	TOP SHEATH ASSY	2
3	46/1181	9" WINDING HANDLE	2
4	46/317T2	CABLE ASSEMBLY (FOR REFERENCE ONLY)	1
5	10/4069	SHACKLE ASSEMBLY	2

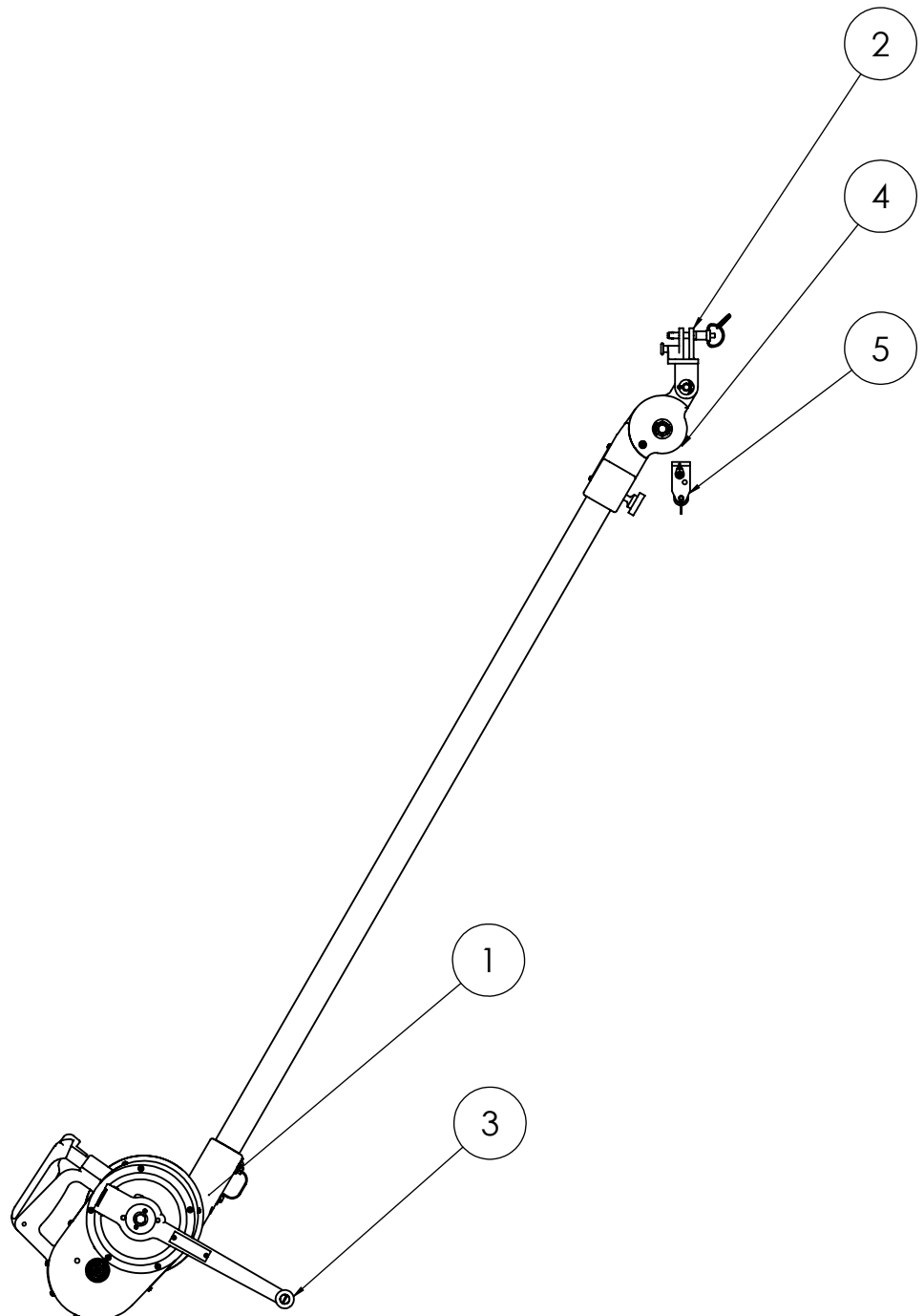

HEIGHT OF LIFT: 8.5M

SWL: 254Kg

WEIGHT: 17.5Kg (Per Hoist Kit)

REV. 9 13/04/17 ADB

# AIRCRAFT APPLICATION SHEET

## 10/3641C1S HOIST KIT

### FISHPOLE HOIST KIT

CONFIGURATION 1:

BOEING 737, 737 MAX, CLASSIC, NG AND B737BBJ APU R/I

BOMBARDIER C SERIES APU R/I

# didsbury

World class lifting and handling solutions

**Didsbury Engineering Co Ltd**

Telephone: +44 (0)161 486 2200  
Facsimile: +44 (0)161 486 2211  
Email: sales@didsbury.com  
Web: www.didsbury.com

ITEM NO.	PART No.	DESCRIPTION	QTY
1	10/4054	FISHPOLE HOIST ASSEMBLY	1
2	91/659	TOP SHEATH ASSY	1
3	46/1181	9" WINDING HANDLE	1
4	46/317T2	CABLE ASSEMBLY (FOR REFERENCE ONLY)	1
5	10/4069	SHACKLE ASSEMBLY	1

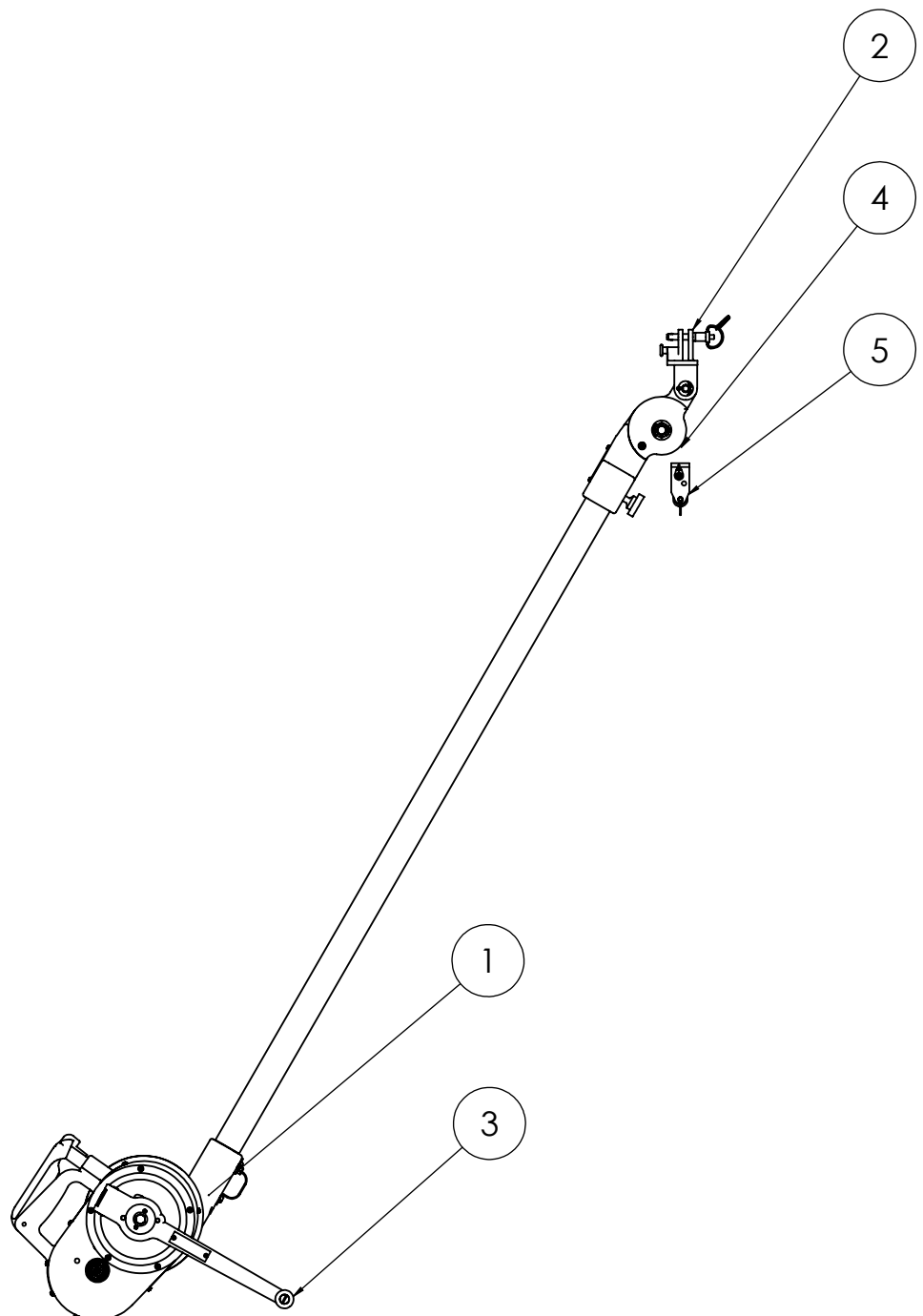

HEIGHT OF LIFT: 8.5M  
SWL: 254Kg  
WEIGHT: 17.5Kg (Per Hoist Kit)

REV. 9 13/04/17 ADB

# AIRCRAFT APPLICATION SHEET

## 10/3641C2 HOIST KIT

### FISHPOLE HOIST KIT

BOEING 747 APU R/I

2 KITS POSITIONED AFT USING 41/453, 1 KIT POSITIONED FWD USING 41/102  
 CONFIGURATION 1 CAN BE ASSEMBLED WITH THIS KIT - SEE 10/3641C1 FOR  
 LIST OF APPLICATIONS



World class lifting and handling solutions

**Didsbury Engineering Co Ltd**

Telephone: +44 (0)161 486 2200  
 Facsimile: +44 (0)161 486 2211  
 Email: sales@didsbury.com  
 Web: www.didsbury.com

ITEM NO.	PART No.	DESCRIPTION	QTY
1	10/4054	FISHPOLE HOIST ASSEMBLY	3
2	41/110	EXTENSION TUBE COUPLING	3
3	41/453	698mm EXTENSION TUBE	2
4	91/659	TOP SHEATH ASSY	3
5	41/102	1219mm EXTENSION TUBE	1
6	46/1181	9" WINDING HANDLE	3
7	46/317T2	CABLE ASSEMBLY (FOR REFERENCE ONLY)	1
8	10/4069	SHACKLE ASSEMBLY	3

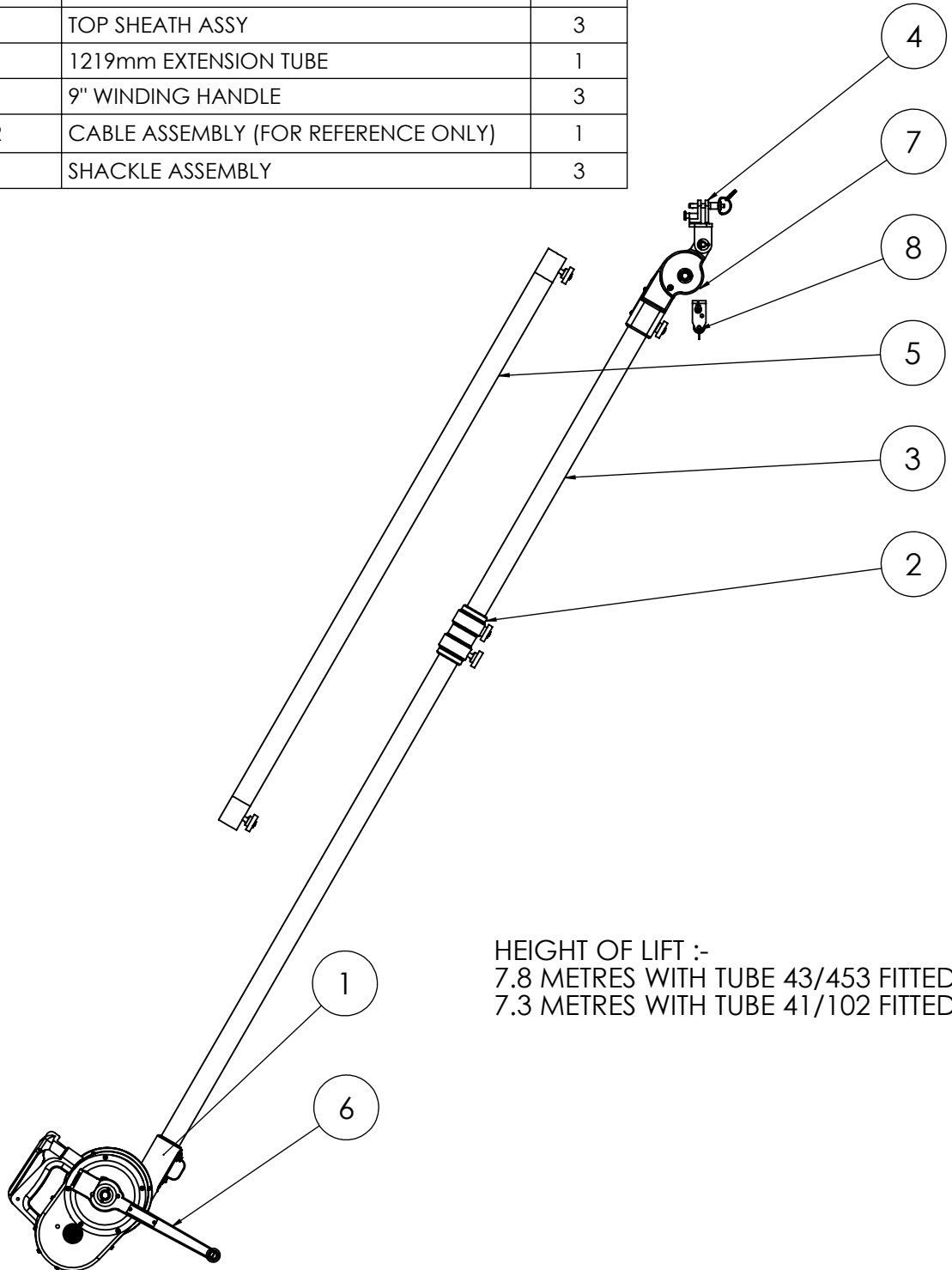

HEIGHT OF LIFT :-  
 7.8 METRES WITH TUBE 43/453 FITTED  
 7.3 METRES WITH TUBE 41/102 FITTED.

HEIGHT OF LIFT: See Sheet  
 SWL: 254Kg  
 WEIGHT: 19Kg (Per Hoist Kit)

# AIRCRAFT APPLICATION SHEET

## 10/3641C3 HOIST KIT

### FISHPOLE HOIST KIT

BOEING 757/767/777/787 APU R/I

THE KIT INCLUDES ONE ADDITIONAL EXTENSION TUBE 41/100 AND COUPLING 41/110 FOR USE WHERE MAINTENANCE PLATFORMS OR STAGING NECESSITATE EXTENDED TUBE LENGTHS.

B777 & B787 USE OF STAGING REQUIRED.

CONFIGURATION 1 CAN BE ASSEMBLED WITH THIS KIT - SEE 10/3641C1 FOR LIST OF APPLICATIONS

# didsbury

World class lifting and handling solutions

**Didsbury Engineering Co Ltd**

Telephone: +44 (0)161 486 2200  
 Facsimile: +44 (0)161 486 2211  
 Email: sales@didsbury.com  
 Web: www.didsbury.com

ITEM NO.	PART No.	DESCRIPTION	QTY.
1	10/4054	FISHPOLE HOIST ASSEMBLY	2
2	41/110	EXTENSION TUBE COUPLING	3
3	41/468	406mm EXTENSION TUBE	2
4	91/659	TOP SHEATH ASSY	2
5	41/100	610mm EXTENSION TUBE	1
6	46/1181	9" WINDING HANDLE	2
7	46/317T2	CABLE ASSEMBLY (FOR REFERENCE ONLY)	1
8	10/4069	SHACKLE ASSEMBLY	2

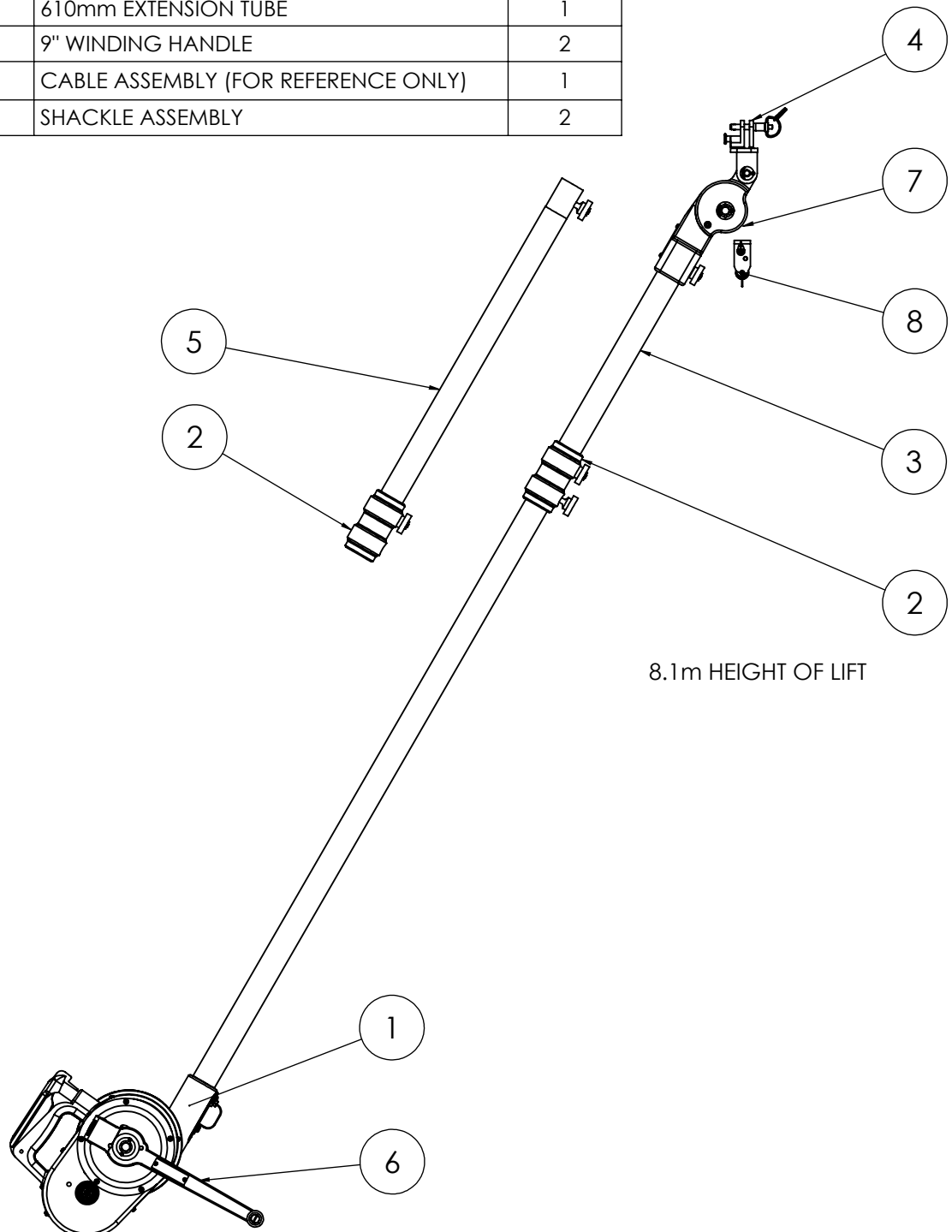

8.1m HEIGHT OF LIFT

SWL: 254Kg  
 WEIGHT: 18.5Kg (Per Hoist Kit)

REV. 9 13/04/17 ADB